

<b>nominal voltage:</b>	1,2V	conditions
<b>max. charge voltage:</b>	1,5V	at standard charge (0,1C / 20°C)
<b>capacity</b>		
nominal :	10000mAh	discharge at 0,2C
	8300mAh	discharge at 1C
minimum:	9300mAh	discharge at 0,2C
		1,0V end discharge voltage
		ambient temperature 20°C
<b>max. continuous discharge current:</b>	10A	ambient temperature 20....50°C
<b>charge</b>		
standard charge:	charge current 1000mA	charge time 16hrs
rapid charge:	2500mA	4,4hrs
fast charge:	5000mA	2,2hrs
recommended charge	-dV: 0....5mV	
termination control	dT/dt: 0,8....1°C per min	
parameters:	TCO: 45....50°C	
trickle charge current:	100....500mA	(recommended)
continuous overcharge: (less than 1 year)	≤750mA	no conspicuous deformation, no leakage
<b>internal resistance:</b>	≤15mOhms	at 1000Hz, battery fully charged
<b>life expectancy:</b>	>500 cycles	IEC standard
<b>ambient temperature range:</b>	0....45°C 10....40°C -20....60°C -20....35°C -20....45°C	standard charge fast charge discharge storage less than 6 months storage less than 1 month

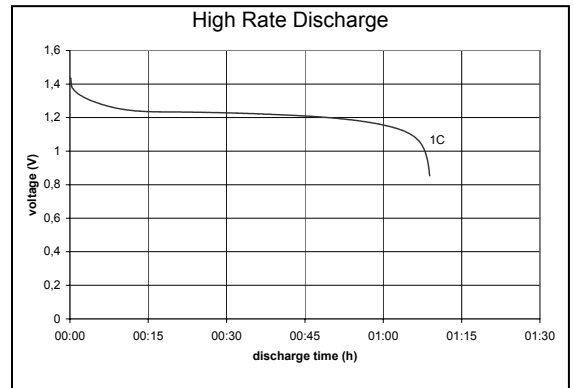

**HY-LINE®**  
POWER COMPONENTS  
HY-LINE AG Tel.: +41 (0) 52 647 42 00  
Grüdenstrasse 82 Fax: +41 (0) 52 647 42 01  
CH-8247 Flurlingen E-Mail: power@hy-line.ch  
Schweiz URL: www.hy-line.ch

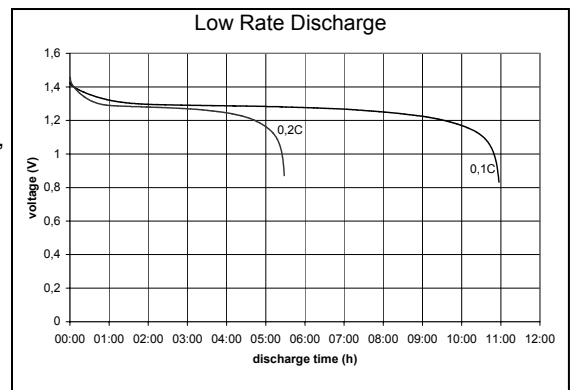
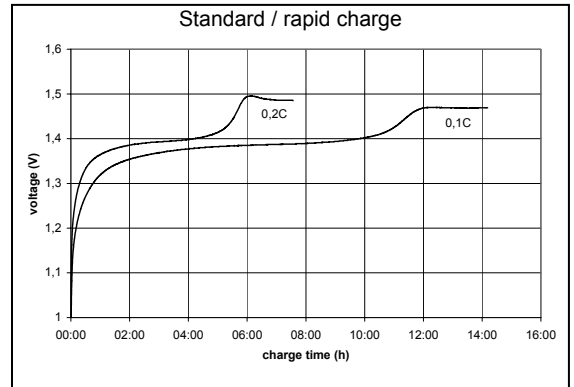
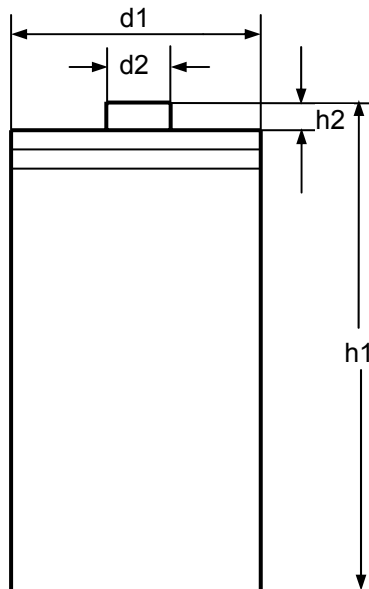

**mechanical specifications**  
cell dimensions (with sleeve)  
diameter d1: 33,0 -1,0mm  
diameter d2: 8,0 ±1,0mm  
height h1: 61,5 -2,0mm  
height h2: min. 1,5mm  
weight: approx. 155g

	specifications for model/type:	D – NiMH 10000mAh
	Ansmann drawing number / part number:	5030641
	drawn by / date:	Gramlich / 27.12.2005